

# Roller Track™ Universal Bracket – Hillphoenix® Cooler

Installation Instructions for Hillphoenix® Coolers

Page 1

**Note: Determine if the Roller Track™ will be installed into a Hillphoenix® Cooler or a Hussmann® Cooler and proceed accordingly. There are two sets of brackets enclosed in the packaging that are specific to the cooler manufacturer. Choose the brackets that correspond to your cooler and proceed accordingly.**

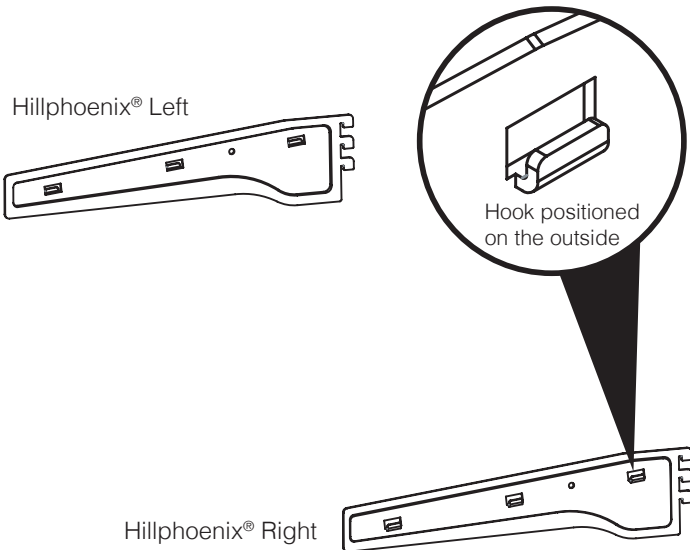

## ① POSITION SIDE BRACKETS

The brackets are labeled “Hillphoenix® Left” and “Hillphoenix® Right”. The left and right is from the front of the shelf perspective.

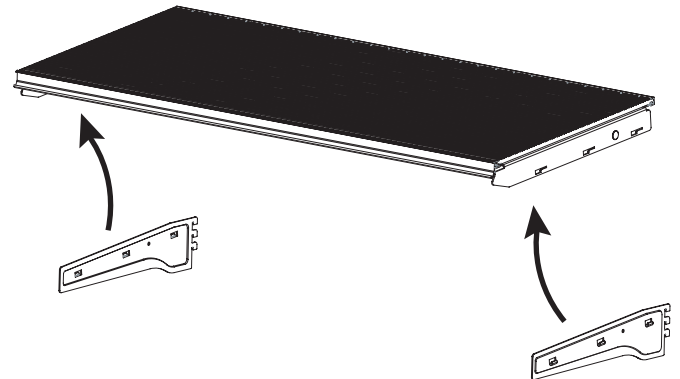

## ② ATTACH SUPPORTS

For the Hillphoenix® cooler, the bracket will attach to the inside of the Roller Track™ metal support.

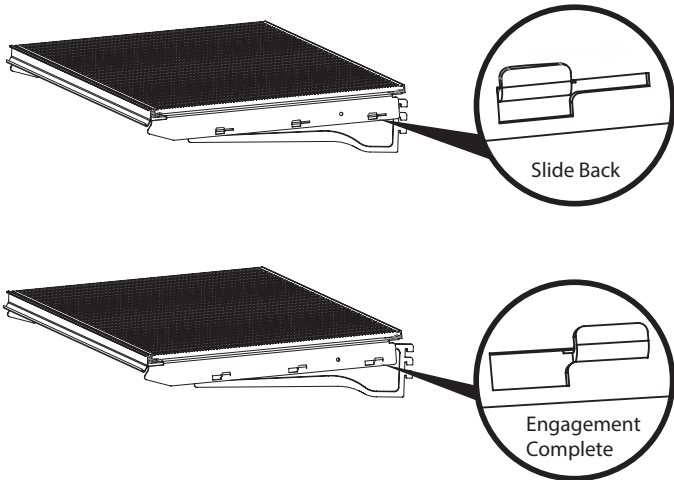

## ③ ENGAGE SUPPORTS TO BRACKETS

Align the teeth of the brackets with the slots on the Roller Track™ metal support. Once teeth are engaged with support, slide the bracket towards the back of the Roller Track™ to secure into place.

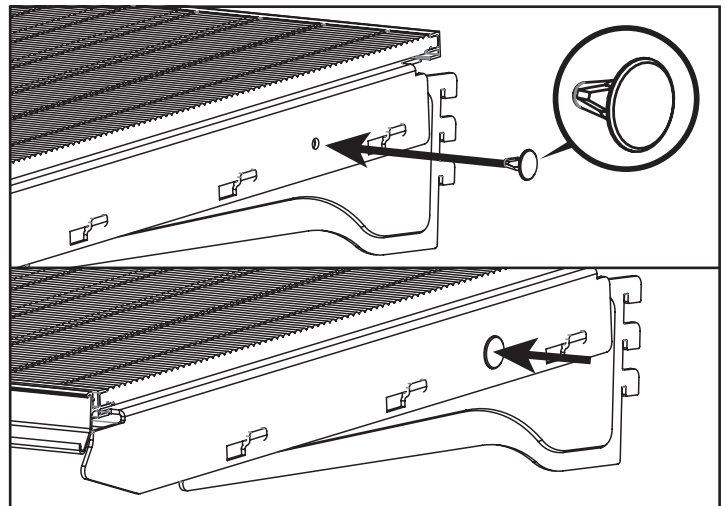

## ④ INSERT ALIGNING PIN IN HOLE ON EACH BRACKET

Push the provided pins into the aligning holes; successful insertion confirms proper alignment.

20190116

For more information,  
call **800.422.2547**  
visit **www.siffron.com**

470000009

**siffron**™  
always on

# Roller Track™ Universal Bracket – Hussmann® Cooler

Installation Instructions for Hussmann® Coolers

Page 2

**Note: Determine if the Roller Track™ will be installed into a Hillphoenix® Cooler or a Hussmann® Cooler and proceed accordingly. There are two sets of brackets enclosed in the packaging that are specific to the cooler manufacturer. Choose the brackets that correspond to your cooler and proceed accordingly.**

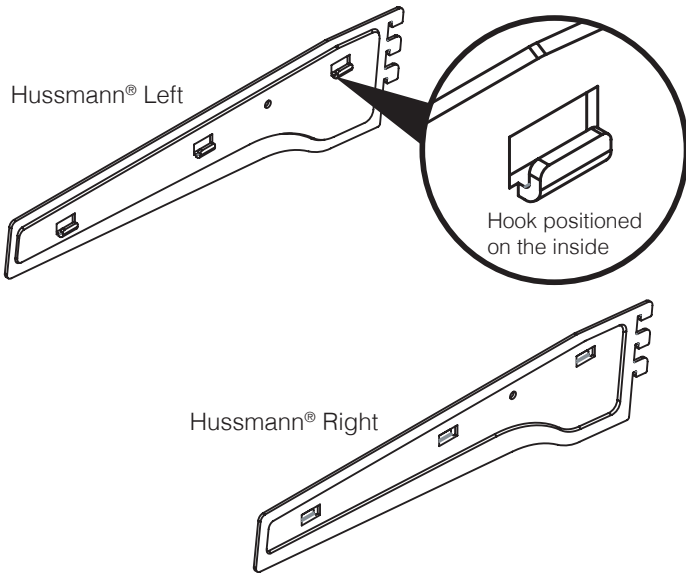

## ① POSITION SIDE BRACKETS

The brackets are labeled “Hussmann® Left” and “Hussmann® Right”. The left and right is from the front of the shelf perspective.

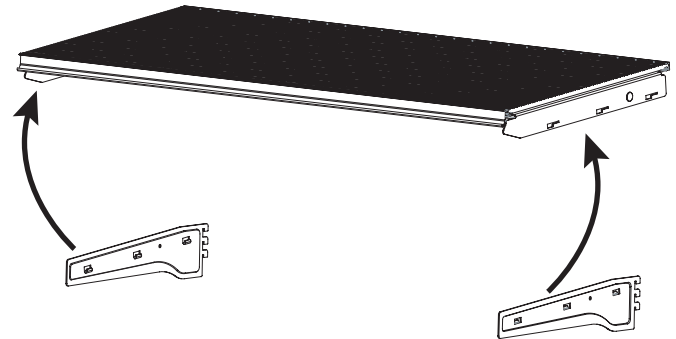

## ② ATTACH SUPPORTS

For the Hussmann® cooler, the bracket will attach to the outside of the Roller Track™ metal support.

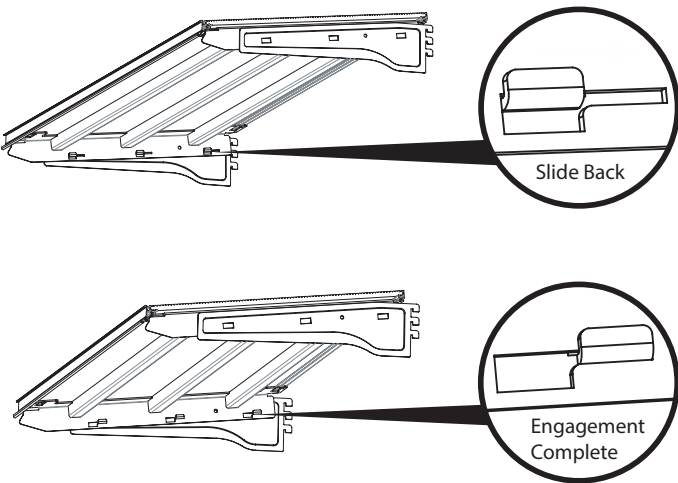

## ③ ENGAGE SUPPORTS TO BRACKETS

Align the teeth of the brackets with the slots on the Roller Track™ metal support. Once teeth are engaged with support, slide the bracket towards the back of the Roller Track™ to secure into place.

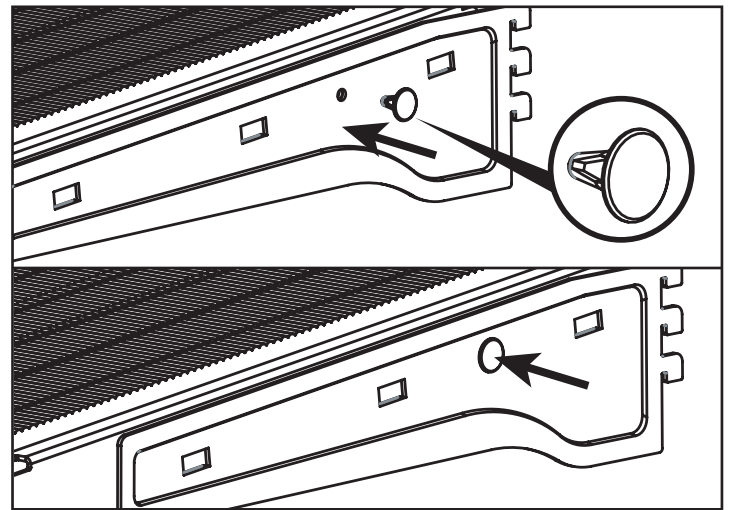

## ④ INSERT ALIGNING PIN IN HOLE ON EACH BRACKET

Push the provided pins into the aligning holes; successful insertion confirms proper alignment.

20190116

For more information,  
call **800.422.2547**  
visit **www.siffron.com**

470000009

**siffron**™  
always on